



CSN® SCREW-IN HEATER VERSION WITH Ø 11,5 MM AND Ø 16 MM TUBULAR HEATERS

11,5 mm dia. threaded joint G 2" ERCH III/
with 3 tubular heaters 16 mm dia. threaded joint G 2½" ERCH IV/

Application:

Heating of fluids or gases

Advantages:

Compared with conventional heaters reduced dimensions and the same ratings. Lower surface load compared with conventional heaters.

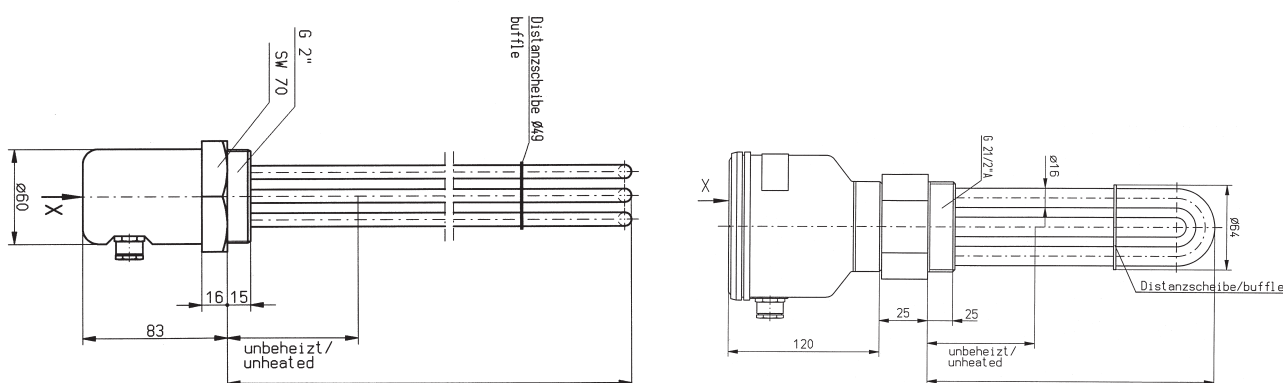

WITH STAINLESS STEEL CASING

type	mounting-in length mm	voltage volts	capacity watts	surface load W/cm2	non-stock item
ERCH III / 20	200	400 3N~	2500	7,0	
ERCH III / 25	250	400 3N~	3000	6,4	
ERCH III / 35	350	400 3N~	4500	6,6	
ERCH III / 45	450	400 3N~	7500	8,3	
ERCH III / 65	650	400 3~	10000	7,5	
ERCH III / 80	800	400 3~	12000	7,2	
ERCH IV / 25	250	400 3N~	4000	6,6	
ERCH IV / 35	350	400 3N~	6000	6,6	
ERCH IV / 45	450	400 3N~	9000	7,5	
ERCH IV / 65	650	400 3~	13500	7,5	
ERCH IV / 80	800	400 3~	16000	7,1	

Specialist contact person:

Bernd Tigges

Phone: +49 2392 - 692 - 42
Fax: +49 2392 - 692 - 8942
eMail: bernd.tigges@schniewindt.de

Stephan Drüeke

Phone: +49 2392 - 692 - 43
Fax: +49 2392 - 692 - 8943
eMail: stephan.drueeke@schniewindt.de